

VARME

Floor Heating Systems

Thermal Substrate Boards

Energy saving construction boards

- 6-60mm Sheets
- Lightweight
- Energy Saving
- Walls / Floors
- Waterproof
- Underfloor Heating
- Bathrooms / Showers
- Extremely Versatile
- Tiling / Plastering
- Internal / External

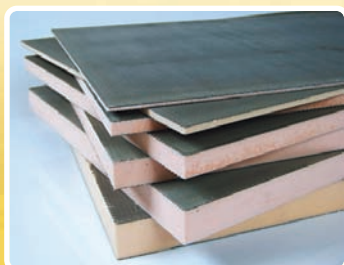

Section through wall showing heatflow

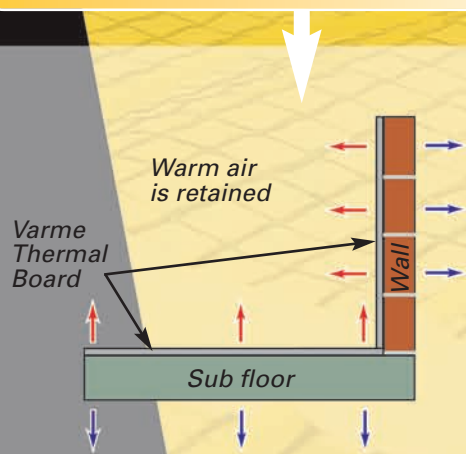

Underfloor Heating

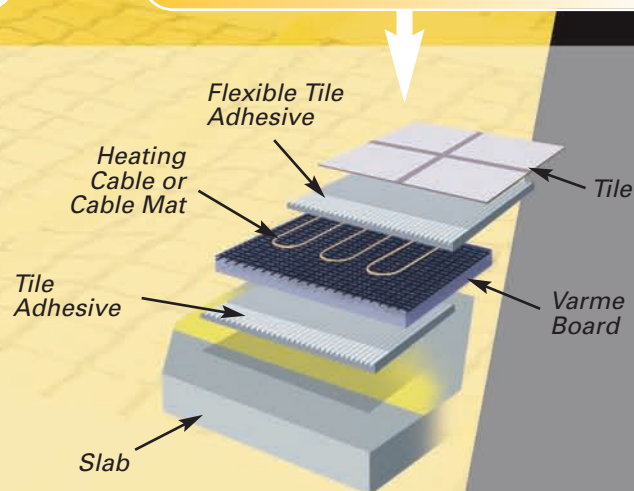

Board Sizes

Thickness (mm)	Width (mm)	Length (mm)	Weight (kg/board)	U Value (W/m ² k)
6	600	1200	2.36	4.50
10	600	1200	2.37	2.70
20	600	1200	2.59	1.35
30	600	1200	2.81	0.90
40	600	1200	3.03	0.67
50	600	1200	3.25	0.54
60	600	1200	3.47	0.45

Accessories

- Stainless Steel/Coated Steel Screws (25-75mm)
- Stainless Steel/Polymer Washers (35mm dia.)
- MS Polymer Sealant Adhesive (290ml tube)
- Waterproof Tanking System (20k bag)
- Waterproofing Flexmaster (additive for waterproofing adhesive)
- 90m x 48mm / 50m x 120mm Fibreglass Reinforcement Tape

Varme Thermal Substrate Boards and Products



Varme Offset Shower Tray (pre-grout).
Tiles cut to follow pre-made fall.

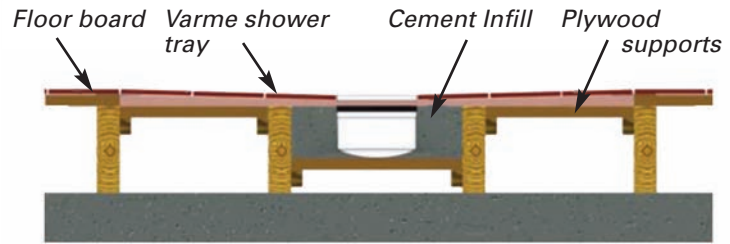

Design Features

- Ready to receive a tiled finish
- Can be cut to fit on site
- Use to create wet rooms
- Ready made falls
- Lightweight
- Use with timber or concrete floors

Varme Shower Tray with Offset Drain

Size (mm)	Perimeter Height (mm)	Weight (kg/board)
1000 x 1000	25	5.3
1200 x 800	25	5.5
1200 x 1000	25	6.3

Varme Shower Tray with Centre Drain

Size (mm)	Perimeter Height (mm)	Weight (kg/board)
800 x 800	20	3.8
900 x 900	20	4.5
1000 x 1000	20	5.3
1200 x 1200	20	7.3

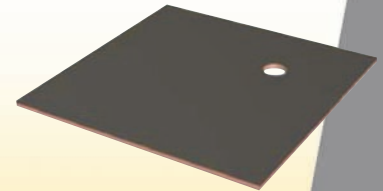

Varme Shower Tray with Offset Drain

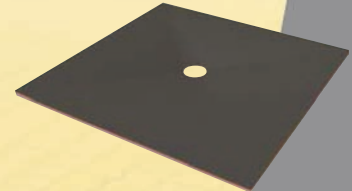

Varme Shower Tray with Centre Drain

Easy Fit Boxed Corners

Varme Angled boards are ideal for boxing-in pipework. Specially designed to enable fast, clean boxing-in of exposed pipework, avoiding the need of a stud work frame. PCS Angled boards are lightweight, insulated and waterproof. They are also suitable for shower areas and wet rooms.

The board is Pre cut to produce a 90° right angle when folded. Simply trim the arms of the Angle Board to the desired size. The board can be easily cut in straight lines and around uneven structures. It can be fixed using silicone directly to adjacent walls or to battens and plastered, rendered or tiled to blend with the surroundings.

Varme Angle Board is 20mm thick and is supplied in 2.4m and 1.2m lengths, and available in the following widths:

- 150mm x 150mm
- 300mm x 300mm
- 400mm x 200mm

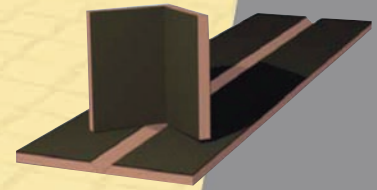

Quickform Pipe Box

Varme Thermal Substrate Technical Data

Properties	Unit	Value
Compressive Strength	(KPa)	300
Thermal Conductivity to BS 874	(W/Mk)	0.027
Thermal Conductivity To BSEN 13164 5 years	(W/Mk)	0.031
Water Absorption	(% by volume)	0.2
Density	(Kg m ³)	36
Flexural Strength (Transverse)	(KPa)	600
Flexural Strength (Longitudinal)	(KPa)	700
Temperature Range	(Deg C)	-50,+75
Fire Performance	BS 476 part 6,7 (Surface Spread of Flame)	Class O